

## Application

The buoyancy proof and practicable plastic sump in high-grade polypropylene (PP) is approved by the German Institute for Construction Engineering (Reg.-N° Z-42.1-410). It is used in pressure drainage systems as well as a standard pump sump. It is suitable for use in areas with traffic load up to 40 tons. (DIN EN 124, group 4). The PKS-D can be placed on natural ground without concrete works. The modular design offers easy transport and installation.

In order to adjust the pumping stations to the required pumping conditions a wide range of MultiCut submersible sewage pumps is available, both with or without explosion protection.

The sump is available in two versions, with a ladder (SG) using pumps UAK/UFK 25/2 M to 45/2 M and without a ladder using the larger types UAK/UFK 75/2 M and 76/2 M. Both versions have a connection piece for inlet, two sockets with seal for ventilation and cable duct, a facility for installing a flushing connection and a DN 40 pressure outlet.

The standard installation depth without a cover is 2.27 m. The installation depth can be extended to 5.90 m by the use of sump extensions (installation depth in ground water not more than 4 m). The total volume is 1372 litres. The volume storage below the inlet is 396 litres.

If extensions are used, one of the extensions must be ordered with a tie-bar.



- Mark of conformity Z-42.1-410
- Suitable for traffic up to class D 400
- Corrosion-proof
- Buoyancy-proof and ground water proof
- Max. installation depth 5.90 m

## Available pump types

MultiCut pumps  
UAK/UFK 25/2 ME, 25/2 M, 35/2 M, 36/2 M, 45/2 M, 75/2 M and 76/2 M

PKS-D 1000-40 and -D40

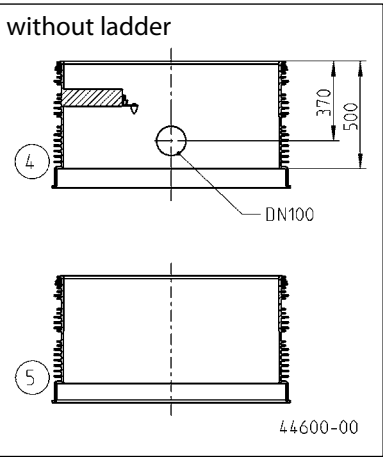
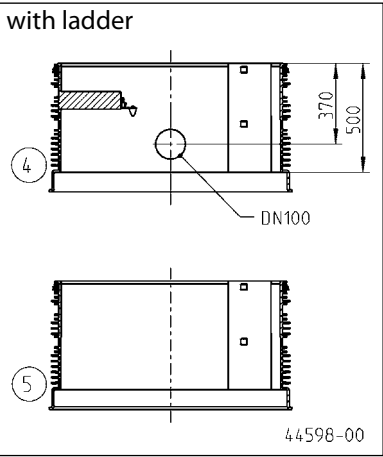
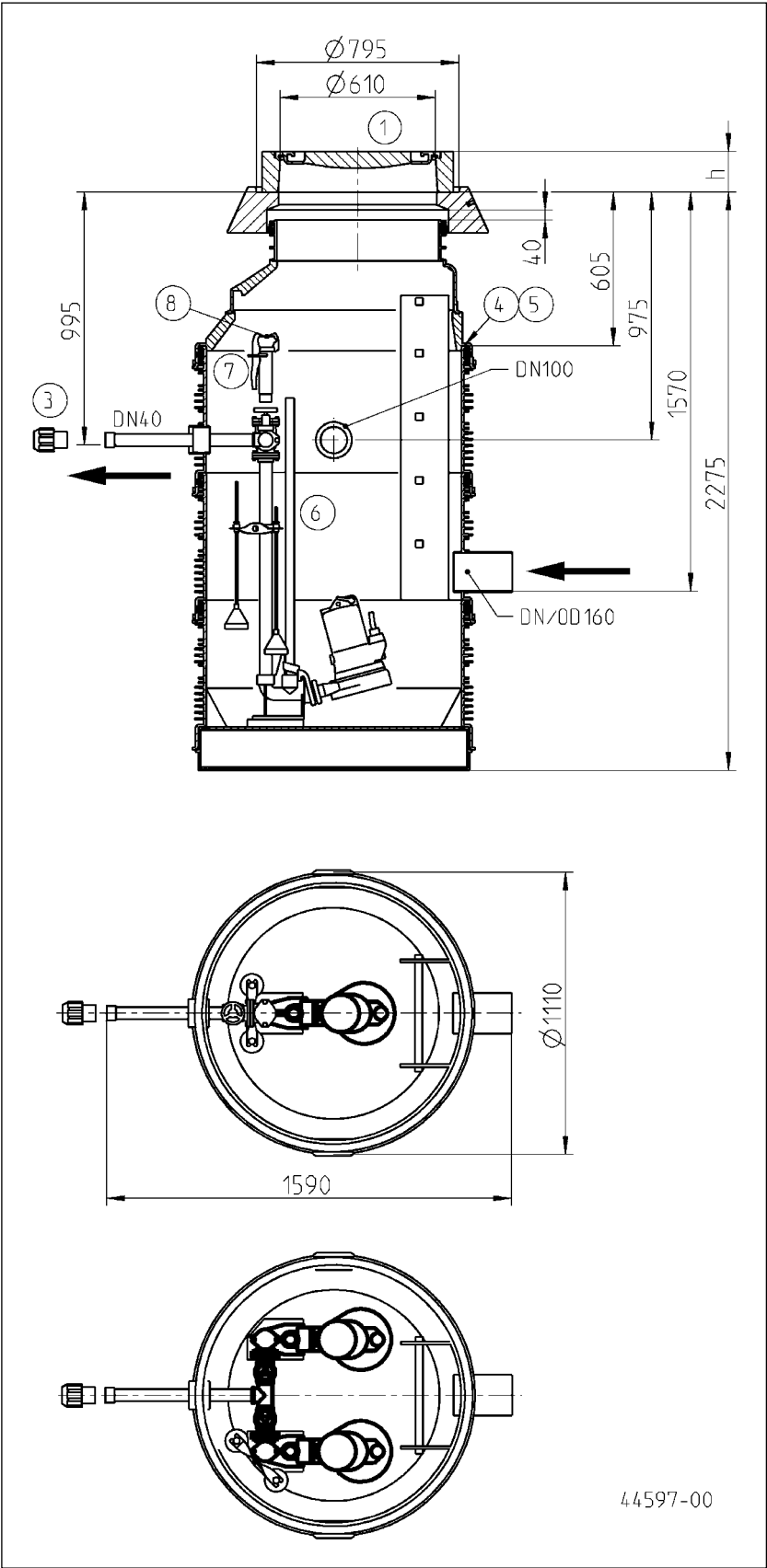

## Scope of supply

### PKS-D 1000-40 (single unit)

The poly-sump consist of an underpart with an inlet and a discharge branch, an extension element, a cone 1000/625 and a concrete support ring for the manhole cover (accessory). The segments are sealed with sealing rings.

Inlet socket DN/OD 160 (DN 150) for PVC collar (KGU), 2 sockets DN 100 for ventilation/cable duct, 1 socket plug DN 100, guide rail system, pipework with elbow ball check valve and stop valve in DN 40, facility for flushing connection system "Perrot".

### PKS-D 1000-D40 (duplex unit)

The poly-sump consist of an underpart with an inlet and a discharge branch, an extension element, a cone 1000/625 and a concrete support ring for the manhole cover (accessory). The segments are sealed with sealing rings.

Inlet socket DN/OD 160 (DN 150) for PVC collar (KGU), 2 sockets DN 100 for ventilation/cable duct, 1 socket plug DN 100, 2 guide rail systems, pipework with elbow ball check valves and stop valves in DN 40, facility for flushing connection system "Perrot".

## Sumps

Type	Code no.	Weight
Poly-sump PKS-D 1000-40	JP 44358	295 kg
Poly-sump PKS-D 1000-D40	JP 44359	330 kg
Poly-sump PKS-D 1000-D40 (75) without ladder	JP 44361	330 kg

## Accessories

Description	Code no.	Weight
① Cover without ventilation, class B d610 h = 125	JP 29174	110.0 kg
Cover without ventilation, class D d610 h = 160	JP 29175	190.0 kg
② Access aid, grab handle	JP 44610	4.0 kg
Access aid, sleeve	JP 44611	1.5 kg
③ Screw joint 1 1/2"- 50mm with female thread and clamping connection	JP 22366	0.3 kg
Screw joint 1 1/2"- 63mm with female thread and clamping connection	JP 22367	0.4 kg
④ PSV-D 1000x500 SG T (10) Tie-bar, ladder	JP 44407	34.0 kg
PSV-D 1000x500 T (10) Tie-bar	JP 44408	32.0 kg
⑤ PSV-D 1000x500 SG (10) Ladder	JP 44403	16.6 kg
PSV-D 1000x500 (10)	JP 44404	15.6 kg
⑥ Guide tube 1" stainless steel 1m	JP 28346	2.5 kg
Sump depth in m	2.27 2.77 3.27 3.77 4.27 4.77 5.27 5.77	
Required guide tube length in m	1.15 1.65 2.15 2.65 3.15 3.65 4.15 4.65	
Attention! For duplex units, two guide tubes are necessary.		
⑦ Fire hose coupling size C 1 1/2" KE	JP 23717	1.2 kg
Perrot flushing connection KE 250 Galvanised	JP 23097	2.0 kg
⑧ Perrot hose connection Ø 50 mm	JP 19202	0.4 kg
Perrot DRS connection	JP 22421	0.5 kg
Perrot breathing valve	JP 22422	0.6 kg
Perrot pressure gauge	JP 24666	1.4 kg
Perrot claw coupling	JP 22420	0.5 kg
Perrot flush connector R 1"	JP 22466	0.3 kg
⑨ Ventilation pipe DN 100 Stainless steel	JP 25437	4.3 kg
⑩ Second inlet DN 150	JP 44523	
Second inlet DN 200	JP 44524	
Second inlet DN 250	JP 44525	
⑪ Seal lubricant 1 kg tube	JP 44605	1.0 kg
Seal lubricant 3 kg bucket	JP 44606	3.0 kg

## Installation example

